

MUSÉE
PLATINUM

For keeping purpose

Warranty Certificate

User's Manual

Musee 3 in Smooth Shaver
MS-YP7016



3 in SMOOTH SHAVER

Thank you for your purchase of Musee Platinum's product.

- In order to use the product safely & correctly, please read the user's manual carefully before using the product.
- Upon reading the manual, please keep the product in a place where you always recognised it.
- When you try to give this product to someone else, please always give it away with this manual attached.

◆ DIRECTORY ◆

◆ Name of the parts	3
◆ Safety Precautions	4
◆ How to charge the product	7
◆ How to attach/detach the attachment	8
◆ Basic Usage	10
◆ Parts of the body that can be used	11
◆ How to take care of the body	12
◆ How to take care of the face	13
◆ How to take care of the V.I.O zone	14
◆ How to clean the product	16
◆ Troubleshooting	18
◆ Frequently Asked Questions	18
◆ Specification of the product	18
◆ Warranty Certificate	19

NAME OF EACH PART

Head Blade

Body Use Attachment

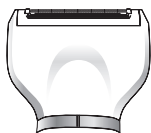

Face Use Attachment



V.I.O Use Attachment



Cover Cap

Body Attachment Cap



Face Attachment Cap



V.I.O Attachment Cover

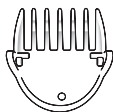

Accessories

USB charging cable

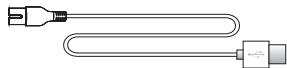

Cleaning Brush

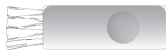

Body Unit



Power (ON/OFF) Button

Charging Indicator Light

Charging port

※Without attachment of AC Adaptor

SAFETY PRECAUTIONS

In order to avoid any harm or damage to a person or to his/her possession, herein the explanation of several matters to be observed without fail.

■ Herein describes the intensity of hazard and damage which caused by improper use of the product.

■ Before use of the shaver, please make sure you read the safety precautions carefully and then use the product correctly.

■ Please follow the designated procedure and use the product reasonably.

■ If the product shows any undesirable function, stop using the product immediately and request a checking/repair.

■ If you continue to use the product in a malfunctioning state, it might bring unfavourable effects to your body and endanger you. Never take the risk, please!

■ The precautions described here contain important information related to safety. Please be sure to follow the instruction.

WARNING

indicates Content that may result in death or serious injury.

CAUTION

indicates Content that may result in minor injury or damage to property.

■ **The following symbols are used to explain what you should**

 Indicates something you should not do.

 Indicates items you should do. (Must be observed)



WARNING

- Please read this “Safety Precautions” carefully before use, and use the product correctly.
- Please follow the prescribed procedure and use the product reasonably.
- If any abnormality occurs in the product, stop using it immediately and contact us.
- Do not use the product while it is in a broken state, as it may adversely affect your health and endanger you. Never take that kind of risk.
- Please be sure to follow and observe the precautions shown here.



- **The following person should not use this product as it could cause accidents and minor to serious skin and body problems for them.**

- Those with metal allergies.
- Those with skin infections or dermatitis.
- Those with sensitive skin.



- **Do not use the product in the following areas as it could cause accidents and minor to serious skin and body problems.**

- Body areas with swelling, pimples or suppurative diseases.
- Areas with skin abnormalities such as excessive sunburn.
- Areas with thin skin such as eyelids.
- Loose skin.



- **Warning! Avoid the following actions, they may cause injury or accidents.**

- Do not keep the product at which children and pet are accessible.
- Do not put the product in a microwave oven or high-pressure container.
- Do not use, charge or store the product near a fire.

BEFORE USE



WARNING STORAGE METHOD



- Keep away the product from fire and keep it out of reach of children and pets.
- Keep the product in a dry place. Leaving the product in a humid place like a bathroom etc. may result in condensation or rusting inside the product and cause malfunction.



PRECAUTION STORAGE METHOD



- Do not press hard on the outer blade or touch it with a finger/fingernail (This action may damage your skin & shorten the life of the outer blade)

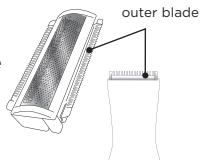

- Do not share it with your family or multiple individuals. (It could cause infection and inflammation)
 - Do not drop or the product. (It could damage the product)
 - Do not restructure, disassemble or repair the product (It could cause accidents and injuries)
- ※For repairs,, please contact us.



- Upon usage of the product, if any abnormalities occur to your skin, stop using the product and get a consult from a general practitioner or dermatologist. (For it may worsen the skin condition)
- Before carrying or storing the products, please remember to enclose the product with a lid or cap. (It may cut your skin and even shortens the life of the outer blade)
- Before use of the product, please check for any deformation or damage to the shaver. (Can cause skin damage)

HOW TO CHARGE THE PRODUCT

While charging, the red-light under the power button blinking, and when the charging is complete the white light lights up.

- ① Insert the USB cable into the charging port located at the bottom of the unit.
- ② Plug into an AC adaptor (sold separately) or a USB outlet.
- ③ Upon completion of charging, please remove the USB cable from the unit.

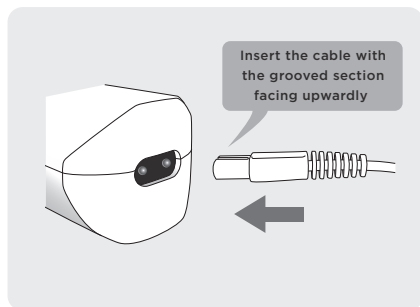

Charging: Red light blinking
Charging completed: White light lights up

Low battery: Red light blinking
※Red light blinking during use indicates low battery

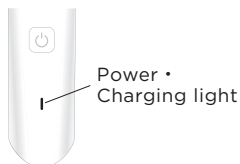

 **※Never charge the unit when the charging port is wet.**

The time needed to charge the unit: approximately 5 hrs (Charging time may vary depending on the battery remaining level and usage environment.)

Operating hour once charged: 1 -1.5 hour

※There is no automatic power-off function.

- When the battery is charged for the first time or has not been used for six months or more, the charging time may change. The charging lamp may not blink for the first few minutes, and the usable time of the product may be shortened. In such cases, charge for at least 8 hours.
- The recommended charging temperature is between 0° C to 35 °C. Beyond the recommended temperature, the charging time may vary and battery performance may decrease.
- There is no problem in charging the battery every time, but it is recommended to charge the battery after the remaining battery is exhausted. The charging life of the battery varies depending on the conditions of use and storage.
- If the battery is not used for more than half a year, the battery will deteriorate. (E.g. fluid leakage) So please fully charge it once every six months.
- Charging for more than 5 hours does not affect the unit.

HOW TO ATTACH/DETACH THE ATTACHMENT

Attachment parts

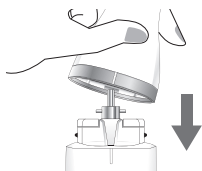

Attach method

- Align the line on the main body with the line of the attachment, and insert until it clicks.
- ※ Insufficient mounting of the attachment may cause injury or damage.



Remove method

- Hold the unit and the attachment firmly and pull until it clicks and separates.
- ※ Be careful not to hurt your hand when removing the attachment.



Face use attachment blade

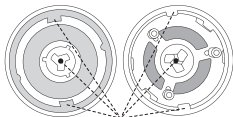

Make sure the parts
in mesh or engaged

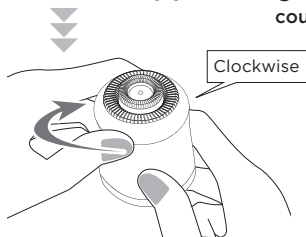

How to install the blade

Align the parts so that they are in mesh, push them straight in and turn clockwise.

How to remove the blade

● Pinch the tip of the attachment, turn it counter-clockwise and pull it up to remove it.

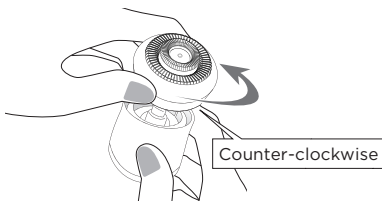



Body use attachment blade

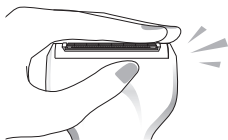

How to install the blade

- Push down the attachment blade evenly to the left and to the right.

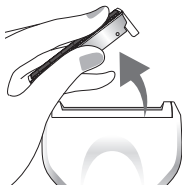

How to remove the blade

- Pull up the attachment blade to remove it.



VIO use attachment cover

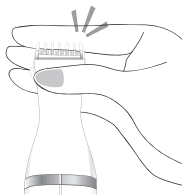

How to attach the cover

- ① Insert the attachment cover into the attachment blade until it clicks.
- ② Confirm that the attachment cover is mounted firm and does not move.

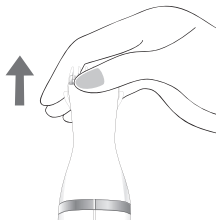

How to remove the cover

- Just pull out the attachment cover with force.

BASIC USAGE

If the hairs are wet, they may cling to the skin or form clumps that are difficult to cut. The lengths of the hairs may not be finished evenly as well.

※ Dry shaving is recommended.

※ Please select the attachment and attachment cover according to your purpose before use.

1 Install the attachment.

2 Press the power button to turn the power ON.

When the power is turned on the white lamp lights up.



3 Stretch the skin of the area to be shaved and gently move the shaver to do the job

※ If the hair is lying downward, shave it from the bottom to the top. Try to raise the hair upward and shave.

4 Press the power button to turn off the power.

※ When the power is OFF, the white light goes out.



BODY PARTS THAT CAN BE USED

○ Can be used ✕ Cannot be used

Part	Face attachment ※treatment of fine and short hair	Body attachment	VIO attachment
VIO Zone	○	○ ※V Zone only	○ ※ I, O Zone used with attachment cover
Face	○	✕	✕
Full back	○	○	○
Underarm	○	○	○
Chest	○	○	○
Arm, hand, finger	○	○	○
Legs	○ ※only on the toes	○	○

⚠ Caution

- ❗ Be sure to use a mirror to check the invisible parts so as not to damage the skin
 ※ Even if you attach a VIO attachment cover to the VIO attachment, it won't guarantee that you won't get an injury.
- ⊘ Do not apply ( prohibited parts)
 Do not press on soft parts.

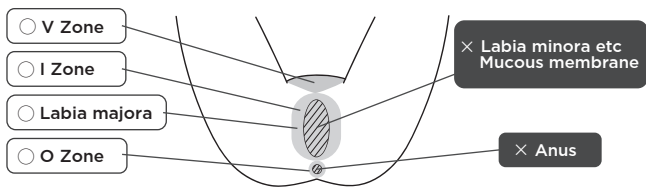

HOW TO TAKE CARE OF YOUR BODY



Body use attachment



Body attachment

1 Firmly stretch the skin

2 Slowly move the shaver on top of the skin toward the reverse direction of the hair

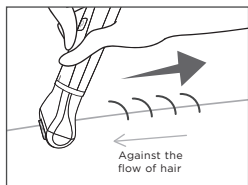

Underarm

- If your hair that needs to be shaved is too dense to process, shave it little by little from top to bottom

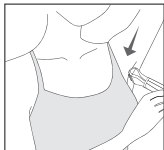

Full Back

- Shave from bottom to top
- ※ Move the device gently over your skin and not to shave your hairs on your

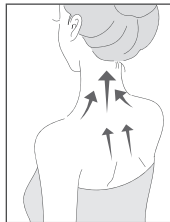

Leg

- Shave from bottom to top

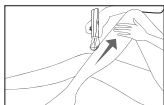

- Shave from outward to inward



HOW TO TAKE CARE OF YOUR FACE



Face use attachment



Face attachment

Apply to face

- 1 Pull the skin taut by hand
- 2 Place the blade perpendicular to the skin and move slowly in a circular motion

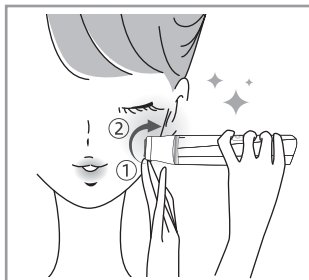

Apply to hand & fingers

- 1 Stretch the skin for easier shaving
- 2 Place the blade perpendicular to the skin and slowly move it in a circular motion

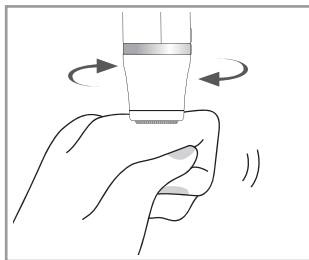

HOW TO CARE FOR V.I.O ZONE

⚠ Caution

- ⊘ Do not apply to prohibited areas.
- Do not press strongly against the skin.
- ❗ Be sure to attach the VIO attachment cover when using the VIO attachment in the I.O zone

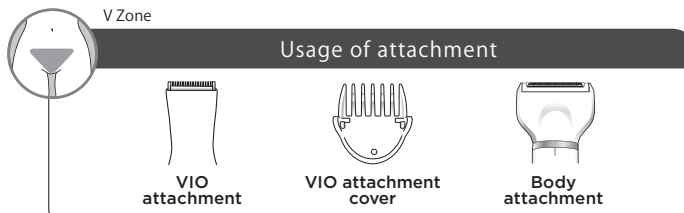

✦ When you want a smooth finish ✦

Cut short with VIO attachment

- 1 Pull the skin taut by hand
- 2 Place the blade near the root of the hair, keep close contact with the skin and shave slowly

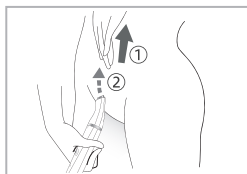

Use body attachment to do the shave

- 1 Pull the skin taut by hand
- 2 Place the net blade perpendicular to your skin and slowly shave up and down

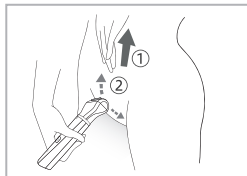

When you want to reduce the number of hairs

Using the VIO attachment cover to shave

- 1 Pull your skin taut by hand
- 2 Place the VIO attachment cover near the root of the hair, keep close contact with the skin and shave slowly

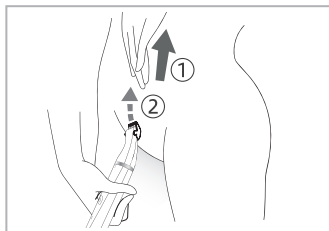

I · O Zone

Usage of attachment



VIO attachment



VIO attachment cover

※I · O Zone can easily get hurt, please be careful when applying on it.

- 1 Pull your skin taut by hand
- 2 Place the VIO attachment cover to the root of hairs, and move the shaver in a direction against the flow of hairs slowly

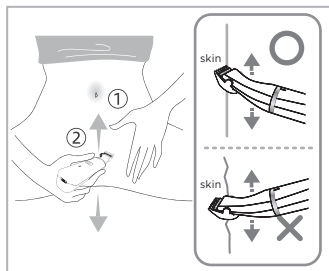

HOW TO CLEAN THE SHAVER

Brush Cleaning

Remove the attachment

Brush off the waste hairs with the inclusive cleaning brush

Body unit

Body attachment

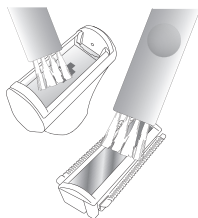
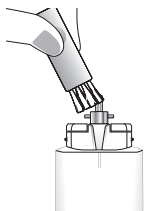

When the shaver is dirty

Rinse the attachment, blade and the main body of the shaver under the running water, shake up and down several times to drain out the water

Body unit

Body attachment

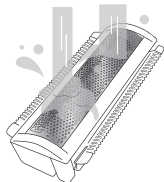

Attachment for face

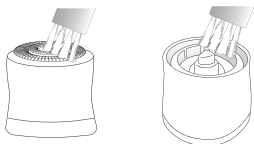

Attachment for VIO



Attachment for VIO



VIO attachment

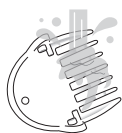

Face attachment

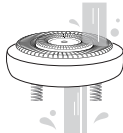

Wiped off the water droplets with a towel,

Let it dry naturally

Removal of the attachment will speed up the drying process.



- When you shaking off the water near the wash basin, please be careful to avoid hitting the basin (cause of damage)
- Please clean the shaver after use (cause of bluntness of the blade)
- Do not wipe the product with thinner, benzine, alcohol etc. (It could be the cause of failure, cracking, and discoloration of parts of the shaver)

IF YOU THINK THAT THE SHAVER IS BROKEN

Symptoms	Reasons could be associated with
The shaving ability becomes poor	● The life of the blade has come to the end, please contact us.
	● The blade may have been deformed, please contact us.
	● The battery may have run out, please charge it.
	● The hairs waste has accumulated to stuck, please clean the Attachment.
The shaver doesn't work	● The battery may have run out, please charge it.
	● The power may have not been turned on, please check if the power is turned on.

- The rechargeable battery is a consumable item. (Not covered by warranty)
- If the usage time becomes extremely short even after charging, the battery may be at the end of its service life. (The average charging times for reference is 500 times.)
- If you wish to replace a new rechargeable battery, please contact us.

Q&A

Can it be used in the bathroom?

- The IPX 7 series product is a waterproof specification, so it can be used in the bathroom.

※But soaking in the water/hot water may cause malfunction.

※Please do not use it in a bathtub filled with hot water. Dropping it in the bathtub may damage the product.

Can it be used by men?

- Men can also use it.

Can use alcohol or ethanol to clean the product?

- No. All types of alcohol, ethanol, benzene, thinner & etc. can not be used to clean the product. (That could result in malfunction, cracking and discoloration of the parts of the product.)

Could the product be used overseas?

- Although it can be used overseas, please check the output rate and shape of the outlet before charging. Please take note that if it breaks down, it will not be covered by the warranty.

Specifications of the Product

- Product Name: Musee 3in Smooth Shaver
- Product Number: MS-YP7016
- Power Supply Method: Rechargeable USB Input (DC5V1A)
- Main Unit Size: H124mm x D28mm x W33mm (Body only)
- Materials: ABS, Stainless steel
- Weight: Approximately 103 g (Body only)
- Usage time: Approximately 1-1.5 h
- Charging Time: Approximately 5h
- Power Consumption: 5W (MAX)
- Country of Manufacture: China

WARRANTY CARD

Product Name	Musee 3in Smooth Shaver
Product Number	MS-YP7016
Warranty Period	1-month warranty from date of purchase: Main body only
Date of Purchase	Year Month Date
*Retailer (store name)	Store name, address, contact

Requests To Retailer:

Please be sure to fill in the fields marked with * and affix your seal before handing it over to the customer.

This document promises that we will repair the product free of charge according to the contents of this document, if a failure occurs during the above "warranty period", please bring this manual to the store where you purchased the product for repair.

- If the required entry fields are blank, or if there is no receipt or statement showing the date of purchase, this document will not be valid.
- This manual will not be reissued, so please keep it in a safe place.