

Product Structure

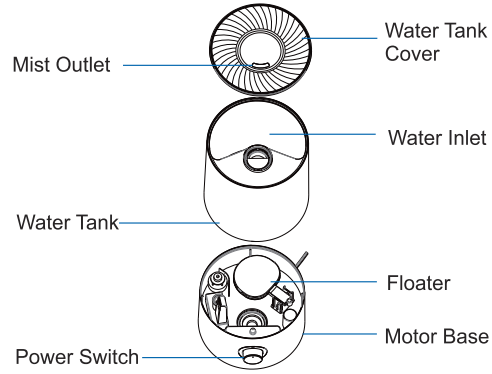

Instructions of Essential Oil & Sanitizer

1. Deroma M350 is designed mainly for the function of humidify your environment. The main function of humidifier is to diffuse water mist.
2. Diffuse water mist will help to reduce the temperature (1-2celcius) and help to avoid dry environment.
3. **Essential Oil and Alcohol Base Sanitizer** is **STRICTLY not allowed** to mix into the water tank and also motor base area, except aroma oil space.
4. Kindly seek advice from the essential oil or sanitizer company regarding the usage of essential oil and sanitizer in Humidifier.
5. Mixture of **essential oil** and **alcohol base sanitizer** into the product will void the warranty.

Packing List

| Parts Name | Quantity |
|--------------------|----------|
| Air Humidifier | 1 |
| Instruction Manual | 1 |
| Warranty Card | 1 |

New Formulated Aroma for Deroma Humidifier

1. Deroma is new formulated water based fragrance with essential oil that is safe for Deroma Humidifier machine.
2. If user wishes Deroma Humidifier can help to diffuse good smell mist for more comfortable environment, **STRICTLY** only use Deroma Water Based Essential Oil that has been tested safe for Deroma Humidifier.
3. Mixture of other essential into water tank will void the warranty as Deroma only will be distributed by selected dealer. Please provide the proof of purchase, if claimed humidifier is damaged due to Deroma essential oil.



Warranty

Warranty is applied upon manufacturing defect only. Warranty does not cover defects and malfunction due to essential oil, human misuse and abnormal voltage or in-coming power supply.

Please register your warranty at below QR Code



**Deroma
Air Humidifier**

M350

Instruction Manual

Innovate With Science & Technology
Succeed With Excellent Quality



Distributed & Marketed by:

Deroma

Address: K1-9, Jalan 3, Taman Seri Merdeka,
68000 Ampang, Selangor.

☎ Call: +603-4288 5351

☎ +6013-556 1199

Website: www.deerma.com.my

E-mail: deromamy@gmail.com

Imported by: Camuniversal Enterprise

Thanks for choosing our product
Read the instruction carefully before use

Products Specification

Product Name: Air Humidifier
 Product Model: M350
 Capacity: 3.5L
 Power: 25W
 Voltage: 220-240V~50/60Hz
 Dimension: Approx. 300*300*170mm
 Weight: Approx. 865g

Failure Analysis and Solutions

Mist knob is switch on, no wind and mist?

Cause: Power is not connected or there is a problem on the power.

Solution: Reconnect power supply. If still unable to function, kindly contact our customer service.

Power is connected, but there is no wind and no mist?

Cause: Water level is not too low.

Solution: Fill water to water tank and re-operate. If still unable to function, kindly contact our CS.

Mist volume is low

Cause: Atomizer is not clean or water is not pure enough.

Solution: Clean the atomizer and replace with clean water.

Abnormal noise

Cause: Water level in the water tank is too low, or product is place on an unstable surface.

Solution: Add water into water tank, and place the product at a solid flat surface.

Product Instructions

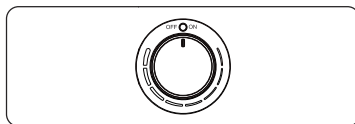

1. Put the humidifier on a flat surface. Remove the water tank cover and water tank from the motor base. Fill water inside the water tank with clean water. (Reminder: Do not insert water into the mist outlet).
2. After finish filling the water, place the cover to the water tank and install back the water tank to the motor base. Connect the power plug to the socket.
3. When the mist control knob is at the on/off position, the humidifier is at standby mode. When the mist knob is switch on, the humidifier is at operating mode (red light indicates lack of water, green light indicates working).
4. When the LED light showing red light, it indicates that the humidifier is lack of water. Turn off the humidifier and refill the water to the water tank. Switch on the humidifier to start the machine.
5. When the LED light is showing green light, it indicates that the humidifier is operating. Adjust the mist level by switching clockwise and counterclockwise.
6. Turn the mist knob clockwise to adjust the mist level from lowest level to highest level, turn the mist knob counterclockwise to adjust the mist level from highest level to lowest level. Turn back to the on/off position to off the humidifier.

Note: When the temperature is too low or the humidity is too high, the mist cannot fully spread to the air, recommend to adjust the mist volume to low level.

Cleaning and Maintenance

Water Tank and Motor Base



Use a clean cloth to wipe the water tank and motor base as figure.

Motor Base and Mist Atomizer

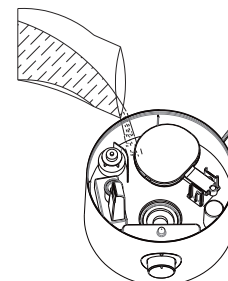

Add detergent powder (for humidifier) with clean water to wash the motor base area. Rinse with clean water and leave it dry.

NOTE:

- * Remember to unplug the power plug before any cleaning or maintenance.
- * Do clean the dirt and stain at the water tank mist tube and motor base of humidifier regularly, recommend once a week or every 2 days if using essential oil or sanitizer.
- * Never use other chemical acids, enzymes or detergents, as it may risk poisonous gas to be created or cause malfunction.

Precautions

1. The power supply voltage must be consistent with the rated power of this product.
2. This appliances is not intended for use by persons (including children) with reduced physical, sensory or mental capabilities, or lack experience and knowledge, unless they have been given supervision or instruction concerning use of the appliance by a person responsible for their safety.
3. Please use the product at normal room temperature (5° C~40° C), humidity: <80%RH.
4. Please put and use the product on a flat surface.
5. Please do not use the humidifier directly on a wooden floor, to prevent the floor from damage.
6. Please put the humidifier 2 meter away from furniture & electronic devices, to prevent from wet.
7. Please prevent the humidifier from heat and direct sunlight.
8. Do not insert water higher than 40° C into the water tank to prevent product from damage.
9. Do not allow water to flow from the air outlet to the body. If there is, wipe it with dry cloth to prevent damage to the machine.
10. If there is any abnormal sound or smell, turn off the humidifier immediately.
11. Please do not insert any metal, chemical or detergent to the water tank or base.
12. Turn off the power supply and unplug before pouring the water from the water tank.
13. Do remember to off the power supply and unplug if there is need to adjust, clean and add water. Do not move the product when it is working.
14. Strictly not allowed to insert water into the mist nozzle and air outlet.
15. When cleaning, prevent the product from water.
16. Do not simply disassemble the product.
17. To avoid growth of bacteria, do clean the humidifier regularly.