

# APRESI<sup>®</sup>

TRULY ALUMINIUM

EXPECT THE UNEXPECTED, STAY TUNE FOR INSPIRATIONS ON OUR LATEST DESIGN CONCEPTS

## THE ART OF INVENTION

SYNONYMS WITH "INVENTOR", WE FORESEE THE LIFESTYLES AND NEEDS OF FUTURE DECADES THAT MIGHT BE INVISIBLE TO OTHERS, AND THUS PROACTIVELY INCORPORATE TIMELESS BEAUTY, GREENERY, FINEST QUALITY AND FUNCTIONALITY IN OUR PRODUCT DESIGNS. EXPECT THE UNEXPECTED, STAY TUNE FOR INSPIRATIONS ON OUR LATEST DESIGNS!



### DRIVEN BY THE CREATIVITY IN OUR BLOOD AND A GENUINE PASSION

for ergonomically designed products that contribute to a higher level of living, we constantly pay close attention to all the little details, be it the product design, material, technology or homeowners' needs. Creating the trends, something for everyone!



[www.apresi.com.my](http://www.apresi.com.my) • [www.honglee.my](http://www.honglee.my)

# TRULY ALUMINIUM

EXPRESS STYLE WITH  
SEAMLESS PERFECTION

APRESI®

## THE EDGY APRESI IS NOTHING LIKE ANY CONVENTIONAL KITCHEN YOU'VE SEEN BEFORE

Breathing new life in the kitchen scene with aluminium cabinets, APRESI with its entire aluminium cabinet carcase, has the superiority on the standard wood kitchen as it is corrosion - rust- rot- and termite-proof, making it a good substitute to traditional timber or metal based kitchen cabinets.

APRESI is available in a wide selection of designs, colours and finishes in both customised and modular systems, that can be designed around tastes and lifestyles.

## ENTER THE WORLD OF APRESI'S DREAM-HOME WORTHY, TRULY FUNCTIONAL KITCHENS

The creative mind behind these extraordinary kitchens that goes beyond convention, APRESI brings the ingenious concept of intelligent kitchens to a whole new level. Showcasing a unique and sophisticated blend of first-class quality and aesthetically pleasing appearance, each perfected and thoughtfully crafted APRESI kitchen is casted in aluminium, renowned for its exceptional durability, quality and recyclability.

APRESI, inspired and derived from the word "appreciation", emphasises the company's dedication to constantly deliver quality product and service experience, and ultimately bring on added value to consumer's life by offering a kitchen that makes day-to-day life easier and more enjoyable.



## 100% ALUMINIUM CABINET CARCASE

Aluminium's unique combination of attractive properties which include exceptional recyclability and proven lifetime performance makes it an excellent choice for kitchen cabinets.

APRESI, with its entire aluminium cabinet carcase, has the superiority over the conventional wood kitchen, will certainly melt away all homeowners' worries of rust, corrosion and termites.

Aluminium is also resistant to heat, chemicals and weathering under a range of harsh environmental conditions, making it extremely durable and long-lasting. Comprising non-combustible material, which is safe even in a high temperature environment, aluminium does not burn or release toxic fumes.

As the most sustainable building material in the world, aluminium is a very durable star material with a sleek, modern look and feel that complements all home styles.

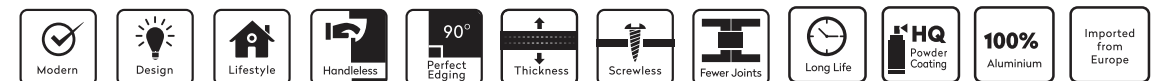

## OUR HARDWARE & FITTINGS PARTNERS



## CERTIFICATION



KITCHEN  
03-08

ACCESSORIES  
09-12

MATERIAL  
13-14

SLIDING DOOR  
15-16

FOLDING DOOR  
17-18

WINDOW  
19-20

MATERIAL  
21-24

PERGOLA & SUN LOUVRES  
25-26

VANITY CABINET  
27

SHOE CABINET & WARDROBE  
28

SECURITY NETTING  
29

GRILLE & INSECT SCREEN  
30



# A SENSE OF CLOSENESS

KITCHEN AS A SOCIAL  
HUB OF YOUR HOME

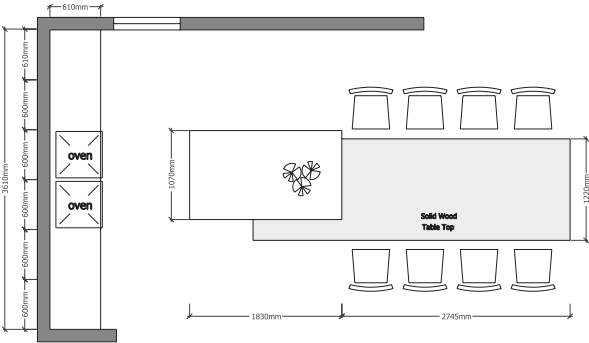

**APRESI®**



Today's kitchens are designed to be the heart of a home, so much more than just a place for preparing meals. Featuring a large integrated dining top, this kitchen doubles up as a great place for enjoying social gatherings with families and friends.



## MODERN RETRO STYLE

MERGING THE BEST OF  
BOTH STYLES

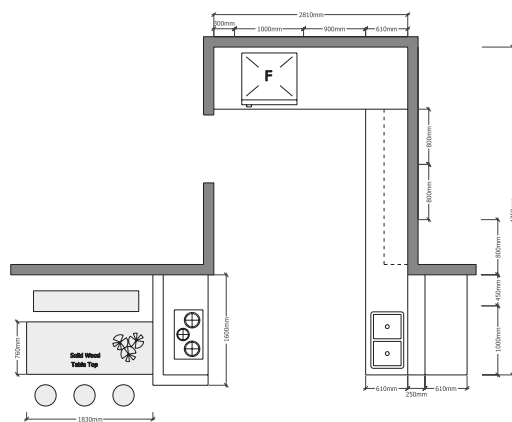

APRESI®



Kitchen trends come and go, but pairing APRESI's sleek and modern kitchen cabinets with retro touches will never go out of style. Featuring a blend of perfect harmony – oozing timeless and sophisticated appeal.



## UNIQUE AND VIBRANT STYLE

BRING KITCHENS TO LIFE  
THROUGH PERSONALITY

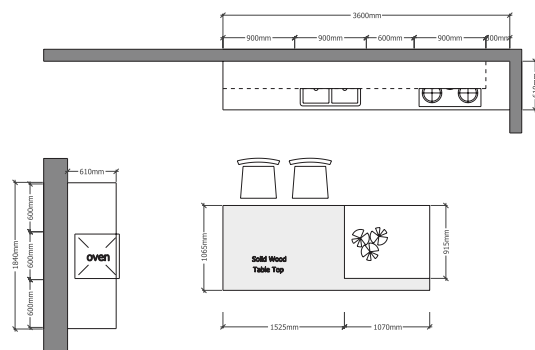

APRESI®







## KITCHEN ACCESSORIES

ENHANCING FUNCTIONAL ELEMENTS  
OF COMFORT

**APRESI®**

## SOLUTION FOR EASY ORGANISATION

A smart combination of cabinets and fittings is essential in increasing the visual space of your kitchen and also to keep all necessities tucked away neatly.

With APRESI's intelligent kitchen cabinetry, it is easy to achieve maximum visual impact with best user experience as well as great functionality in your kitchen. Fitting systems from APRESI ensure high quality of motion, ample storage capacity, exceptional usability and excellent accessibility.



### PULL-OUT TRAYS

Fully extendable pull-out trays transform your tall cabinet into a smart pantry, always keeping things in sight and within reach.



### HIGH FRONTED PULL-OUTS

Effortlessly maximise the use of your cabinet interior space to organise and store everything neatly and conveniently.



### INNER DRAWER

Drawers within drawers allow you to keep your cutleries and cooking utensils uncluttered.



## KITCHEN ACCESSORIES

We dedicate ourselves unceasingly to constantly deliver quality kitchen accessories, and thus APRESI's ergonomic mechanism is guaranteed to make your everyday life easier.

Resembling a sleek-looking pendant, this innovative invention is seamlessly integrated into the stay lifts in top wall cabinets, allowing for effortless and smooth closing.



Our commitment to quality is not just an empty promise, therefore we make certain that product quality is the cornerstone of everything we do. APRESI's ergonomically planned, innovatively designed kitchens allow for thoughtful organisation of workspace, easily adaptable to define spaces based on your needs.

Be it parallel lift up, stay lift, bi-fold lift or swing up, APRESI opens the door on a multitude of high quality kitchen fitting system possibilities to suit every need. A model of ergonomic excellence, APRESI cutting-edge kitchen accessories provides only the best accessibility and the greatest quality of life.

**APRESI®**



### MAGIC CORNER

Bring your kitchen items into full visibility along with numerous organisational opportunities.



### SEASONING DRAWER

Never hunt for a missing seasoning again and keep them all within grasp with this practical seasoning drawer.



### WASTE SORTING SYSTEM

A simple and effortless approach to an easier and effective recycling. Organising waste is no longer a challenge.



# MATERIAL



## 01 THICK PROFILE

A thickness of approximately 19mm allows for superior durability and stability.

## 02 AESTHETIC

The reduced joint lines offers a significantly more attractive and distinctive look.

## 03 90° PERFECT EDGING

Fully utilise the entire interior space, offering maximum storage capacity.

## 04 CUSTOMISABLE SHELVES

Create your very own cabinet shelves according to your exact needs and preferences

## 05 RUBBER BUFFER

Enhance hygiene by protecting objects inside the cabinet from dust and insects.

## 06 CONCEALED SCREWS

Keep your kitchen cabinets looking their best at all times with the elimination of unsightly screws.

## 07 HIGH PERFORMANCE HINGE

Best-in-class European hinge technology allows smooth and silent closing without damaging the doors.

## 08 HANDLELESS DOOR

Integrated door handle design offers a sleek look and allows for easier opening and better cleaning.

## 09 SMOOTH DRAWER RUNNER

Incredibly tough and unbelievably quiet, reliable and outstanding quality from Germany.

## 10 PATENTED INFILL PANEL

Completely close the gap between your cabinets and the wall by precisely filling in the space.

## 11 HEIGHT ADJUSTABLE LEG

Easy to adjust and perfect for heavy duty use with high load-bearing capacity.

## 12 PATENTED JOINING SYSTEM

Sturdy, positive-fitting and friction-locked along with enhanced strength and own R&D capability.



01

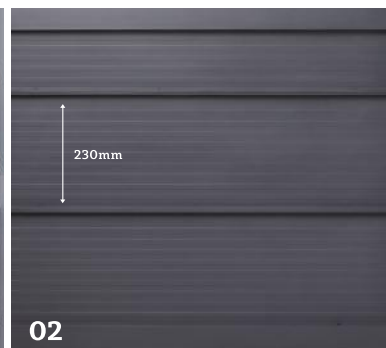

02



03

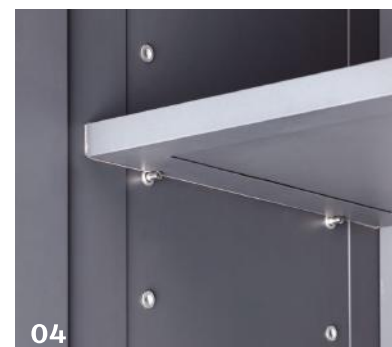

04



05



06



07



08



09



10



11



12



## HIGH PERFORMANCE SLIDING DOOR

OPENING YOUR DOOR  
TO EXCELLENCE



15 - 16



Taking the door capacity to a greater height of 12 feet and a maximum width of 5 feet/panel, HongLee's high performance sliding doors will definitely gives a facelift to your house, and you will be suprised with the fascinating appeal of the linear styling of this multi-panel door.



**HIGH PERFORMANCE  
FOLDING DOOR**

**YOUR GATEWAY TO A  
CALM SERENITY**



HongLee's high performance folding doors with a maximum height of 11 feet and a maximum width of 2.5 feet/panel give you the flexibility to open up some or all of the door panels to desired scale, bringing the outdoors in while enjoying the comfort of being indoors.



HIGH PERFORMANCE  
WINDOW

A BETTER VIEW OF THE  
BEAUTIFUL WORLD



HongLee's high performance windows with extended height of up to 12 feet and a maximum width of 3 feet/panel are great for creating a sense of size, creating a broad expanse of glass that makes the most of natural surroundings.



# HIGH PERFORMANCE WINDOW MATERIAL

Common Outdoor Sound Levels	dBA	Common Indoor Sound Levels
Jet Flyover at 1,000ft. Horn Noise - Train at 1,000ft.	110	110 Dance Club Music Inside Subway Train
Motorcycle at 3ft.	100	100 Mixergrinder at 3ft. Garbage Disposal at 3ft. Very Loud Speech at 3ft.
Diesel Truck at 50ft. General goods Train at 100ft. Noisy Urban Daytime	90	90 Vacuum Cleaner at 10ft.
	80	80 Normal Speech at 3ft.
Commercial Area	70	70 Large Business Office Quiet Speech at 3ft. Dishwasher in Next Room
Heavy Traffic at 300ft.	66	60 Small Theatre, Large Conference Room (Background)
	60	50 Library
Quiet Urban Nighttime	50	40 Bedroom at Night Concert Hall (Background)
Quiet Suburban Nighttime	40	30 Broadcast and Recording Studio
Quiet Rural Nighttime	30	20 Threshold of Hearing
	20	10
	10	0
	0	

## SOUNDPROOF

*Engineered Acoustically As A Sound Barrier*

Significantly reduce external noise levels from approximately 105 dB (equivalent to the noise of motorcycles) to approximately 48 dB (equivalent to the noise of quiet urban night time). Make your home a silent sanctuary with the help of innovative and excellent sound insulation technology.

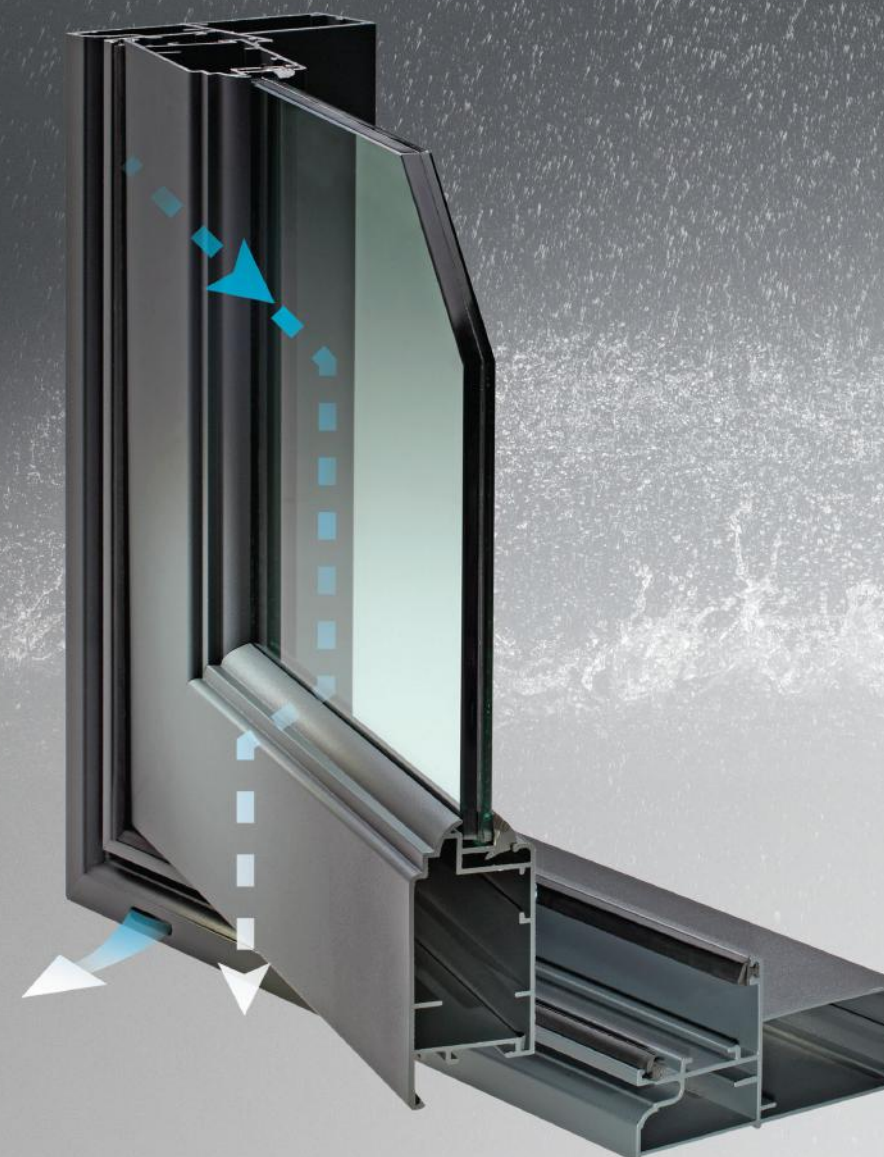

## ANTI-WATER PENETRATION SYSTEM

*Prevent Water Penetration And The Infiltration Of Cold Outside Air*

Equipped with double-layer protection for enhanced water tightness performance in order to help safeguard your home from unwanted water intrusion and excess moisture damage.

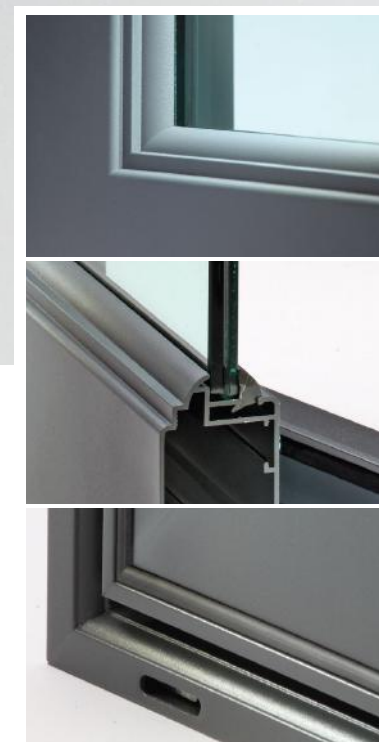

## STRUCTURAL STIFFNESS

*Provide High Strength Wind Protection Insulation*

Reaching a wind pressure resistance class of 3, HongLee's windows observed to withstand the pressure of 1200 Pa (about 160.67 km/h) when closed. This extra layer of strength offers additional valuable protection against strong winds and debris.

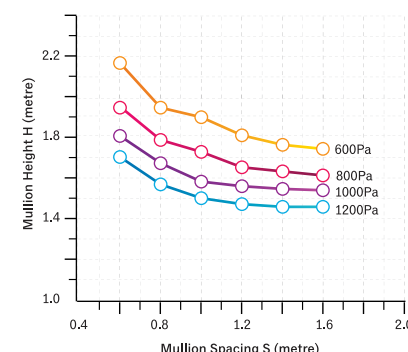

**Wind Load Test**

## ARCHITECTURAL DESIGN

*A Sleek Look For A Distinctive, Curved Appearance*

With enhanced structure and joints along with own R&D capability, our unique profile provides better functionality and durability as well as the ability to integrate with different specifications of glasses, up to a maximum thickness of 11.52mm.



## HIGH PERFORMANCE SLIDING DOOR MATERIAL



IN ADDITION TO ENJOYING ALL SIGNIFICANT BENEFITS OF OUR HIGH PERFORMANCE WINDOWS, HONGLEE'S SLIDING DOORS OFFER OTHER CLEAR-CUT ADVANTAGES INCLUDING:

### 01 HEAVY DUTY ROLLERS

Ensuring a smooth operation at all times with top-notch extruded aluminium track and stainless-steel rollers system.

### 03 EXCELLENT DURABILITY

The unique hollow section design allows the sliding door to reach higher heights and therefore offers a more solid appearance together with finer functionality as well as greater stability.

### 02 INTEGRATED CASTING

Our high performance sliding door presents very few joints with integrated casting. The reduction of joints helps in improving the durability and structural stiffness, providing extra strength and support to the entire door.

### 04 WEATHER SEAL

Handling all of your insulation needs including wind, sound, dust and water for better prevention against the intrusion of dust, moisture and noise as well as to make your home more energy efficient.

## LOCK SYSTEM



### CONCEALED HINGE

High Quality concealed hinges bring about a clean look and better aesthetics while at the same time delivering excellent strength, durability and firm support for smoother opening and closing.

### MULTIPOINT LOCK SYSTEM

A multipoint locking system ensures a higher level of security and provides multiple protection against intruders.

### HANDLE

The integral door fittings allow for a solid latching of the closed window or door and enable a smooth yet easy operation.



## ALUMINIUM PERGOLA & SUN LOUVRES

ELEGANT LIVING FOR  
ALL TIME



2 5 - 2 6



HongLee's pergola and sun louvres with heavy duty aluminium beam and high transparency glass roofing offer not only a stylish way to provide shade and shelter for your loved ones, but also allows you to enjoy outward visibility while protecting yourself from the glaring sun.





## ALUMINIUM VANITY CABINET

### MAKE A SPACE FOR STYLE

A stylish bathroom vanity is the small space solution with big style, but choosing the right material is what makes your settings last. In a high humidity space in most of the bathrooms, a vanity cabinet casted in aluminium will definitely do away worries of rust and corrosion, an innovative solution to keep all your day-to-day essentials neat and out of sight.

## ALUMINIUM SHOE CABINET

### THE ULTIMATE NEAT SOLUTION

Available in both freestanding and suspension units, APRESI's shoe cabinets are immaculately designed to optimise the use of space. Incorporating ventilation panels at the base of the cabinet as well as providing resistance against humidity and weather, aluminium shoe cabinets are perfect for both indoor and outdoor use.



## WALK-IN WARDROBE

### A LUXURIOUS LIFESTYLE FOR ALL

Presenting a totally unique concept in wardrobe organisation, APRESI's walk-in wardrobes are customisable to suit your every need. Free from moisture, rust and rot, they are definitely the optimal solution for all fashionistas. A combination of aluminium main posts, drawers, shelf panels and YOUR creativity.





## STAINLESS STEEL SECURITY NETTING

**YOUR SAFETY. OUR PRIORITY**

The integration of both grille and insect screen in HongLee's stainless-steel security netting provides you with ultimate protection from intruders and insects while simultaneously allowing fresh air into your home. An ideal innovation against break-ins and forced entry.

## ALUMINIUM GRILLE

**CREATING PEACE OF MIND THAT LASTS**

With a unique octagon hollow design, HongLee's aluminium grille offers more than just protection for your loved ones and your home but also a visually pleasing appearance with little to no maintenance necessary.



## MAGNETIC INSECT SCREEN

**MAKE ANY ROOM AN INSECT-FREE ZONE**

This flexible insect screen from HongLee is enhanced with a brilliant magnetic sealing system which allows it to adhere to your windows or doors effortlessly and provide the greatest protection for your loved ones.





#### HEADQUARTERS

#### HONGLEE GROUP (M) SDN. BHD. (1024793-M)

No. 1, Jalan Seroja 38, Taman Johor Jaya,  
81100 Johor Bahru, Johor, Malaysia

T : (60)7-353 7450

F : (60)7-353 7334

E : enuiqry@honglee.my W : www.honglee.my



#### BMS Mall

Unit B. 0109 & 0209,  
6, Jalan Kencana Mas 2/1,  
Kaw. Perindustrian Tebrau III,  
81100 Johor Bahru, Johor

#### Cheras

1, Jalan Mutiara Barat 1,  
Taman Mutiara,  
56000 Cheras, Kuala Lumpur

#### Puchong

Lot F19-F20, 1st Floor, IOI Mall,  
Batu 9, Jalan Puchong,  
Bandar Puchong Jaya,  
47100 Puchong, Selangor

#### Penang

558B Jalan Sultan Azlan Shah,  
11700 Gelugor, Pulau Pinang

#### Miri

Lot 255, Jalan Baiduri 1,  
Pujut 3A,  
98000 Miri, Sarawak

#### Singapore

3007, Ubi Road 1,  
#06-412,  
Singapore 408701

#### Kempas

16, Jalan Kempas Lama 1,  
Kaw. Perindustrian Kempas Lama 1,  
81300 Johor Bahru, Johor

#### Mahkota Cheras

19, 1st Floor, Jalan Temenggung,  
Bandar Mahkota Cheras,  
43200 Cheras, Selangor

#### Seremban

21, Jalan S2 B1,  
Lake View Square,  
70300 Seremban, Negeri Sembilan

#### Kuching

Ground Floor, 550-552,  
Bangunan Cheema, Jalan Palm,  
93400 Kuching, Sarawak

#### Kota Kinabalu

Lot 1, Taman Park,  
Mile 6, Jalan Putatan,  
88200 Kota Kinabalu, Sabah

#### Indonesia

Bengkong Bengkel No.12,  
Batu Ampar Batam,  
Riau 29432, Indonesia

#### Desa Petaling

2-21A, Level 2, Plaza Salak Park,  
Taman Desa Petaling,  
57100 Kuala Lumpur

#### Cheras Selatan

5-1 & 5-2, Jalan C180/1,  
Dataran C180, Batu 11,  
43200 Cheras, Selangor

#### Terengganu

107, Jalan Petani,  
20000 Kuala Terengganu,  
Terengganu

#### Kuching

56-57, Tabuan Tranquility  
Commercial Centre,  
Jalan Canna,  
93350 Kuching, Sarawak

#### Sandakan

Block 10, Lot 91, G & 1st Floor,  
Prima Square, Mile 4,  
90000 Sandakan, Sabah

#### Brunei

Unit 5A, 1st Floor, Block B,  
Eng Ho Complex,  
Spg. 217-5-54 Tungku Link,  
Negara Brunei Darussalam

#### Taman Tun Dr. Ismail

30-1, Jalan Wan Kadir 4,  
Taman Tun Dr. Ismail,  
60000 Kuala Lumpur

#### Puchong

95-2, Jalan BK 5A/2,  
Bandar Kinrara,  
47180 Puchong, Selangor

#### Ipoh

7, Laluan Tasek Timur 3,  
Pusat Perdagangan,  
31400 Ipoh, Perak

#### Bintulu

87, Medan Jaya  
Commercial Centre,  
97012 Bintulu,  
Sarawak

#### Tawau

4197, Jalan Budi, Mile 1,  
Off Jalan Kuhara, P.O. Box 2001,  
91045 Tawau, Sabah

#### Vietnam

Vista Verde Complex,  
Thanh My Loi Ward,  
District 2,  
Ho Chi Minh City

#### COMMERCIAL MARKETING AGENT

#### NuFLO Marketing

498-3-7, Wisma Indah, Jalan Tun Razak,  
50400 Kuala Lumpur