

CraftHausz

Lantern



Experiment Steps





Get to Know the Materials

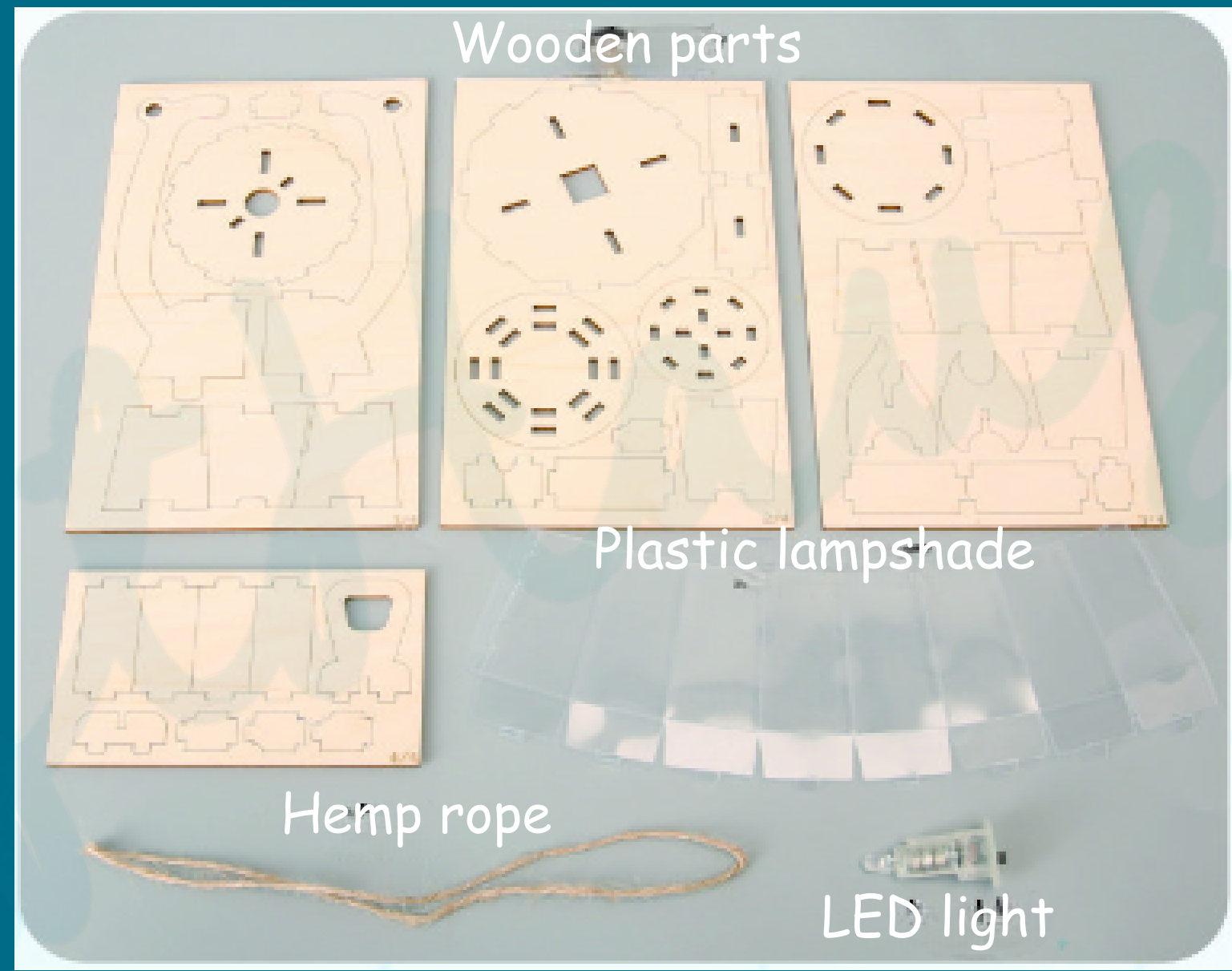

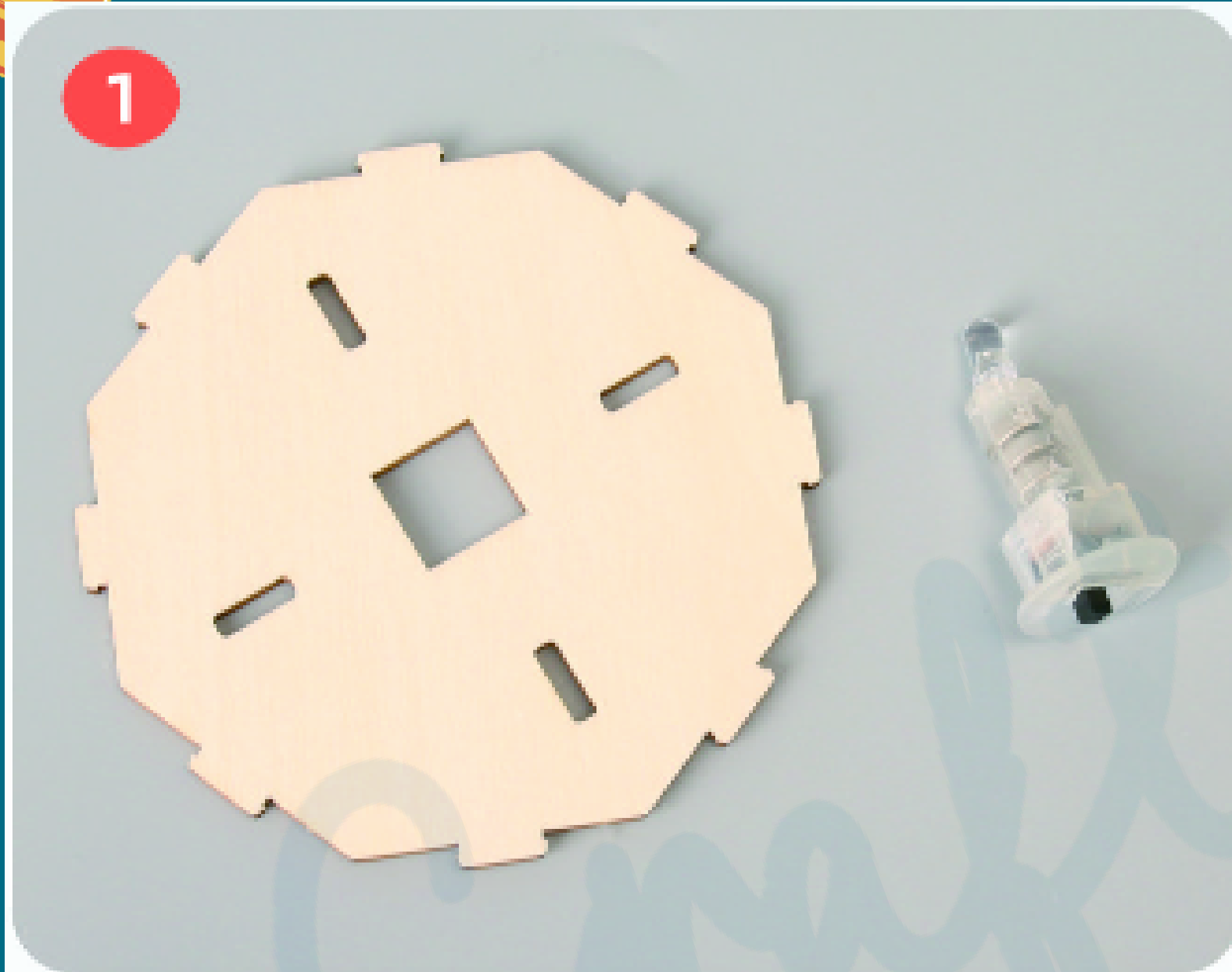

Prepare all materials as shown in the picture.



Install the LED light as shown.
Note: It is installed correctly only when the LED light is securely fastened. If it does not lock in place, adjust its orientation and insert it again.
Prepare the wooden board for the next step.



3 Install the wooden board as shown.

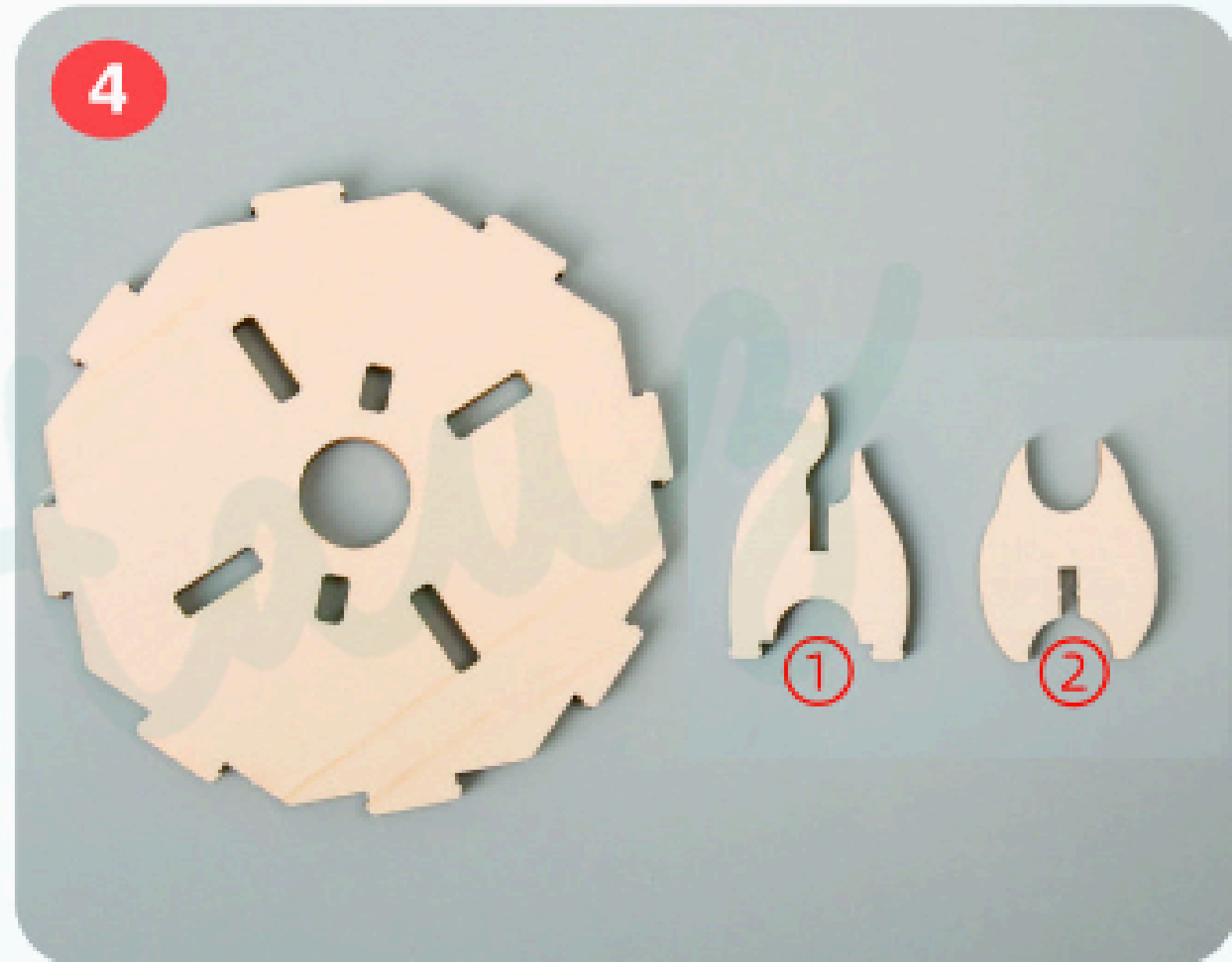

4 Prepare the wooden boards shown in the picture.



注意：先卡①号板
再斜侧将②号板卡
入①号板中

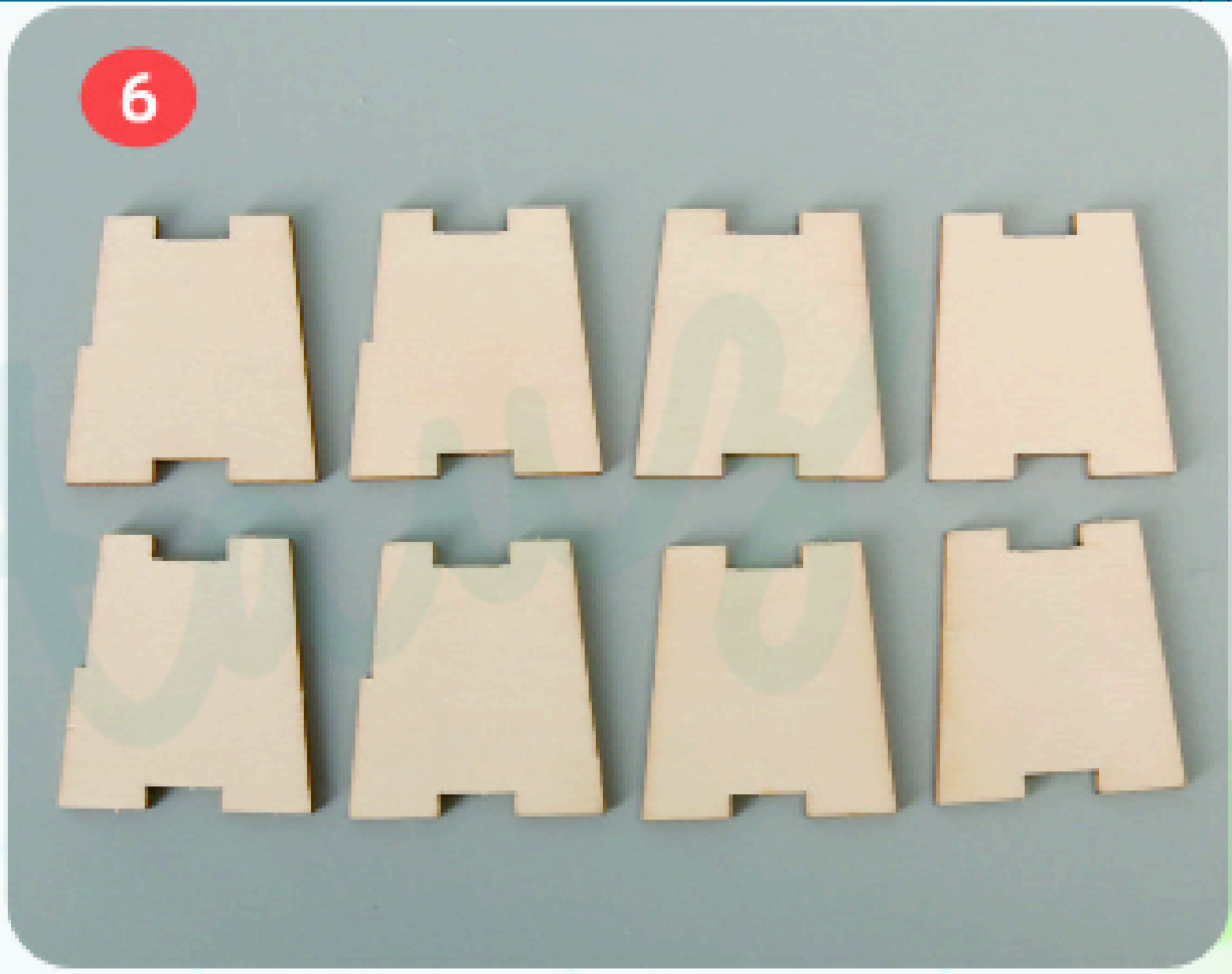

Install the wooden boards as shown.
Note: Install Board 1 first, then insert Board 2 diagonally into Board 1.
Caution: The wooden boards are thin and fragile — handle carefully during installation.

Prepare the wooden boards shown in the picture.

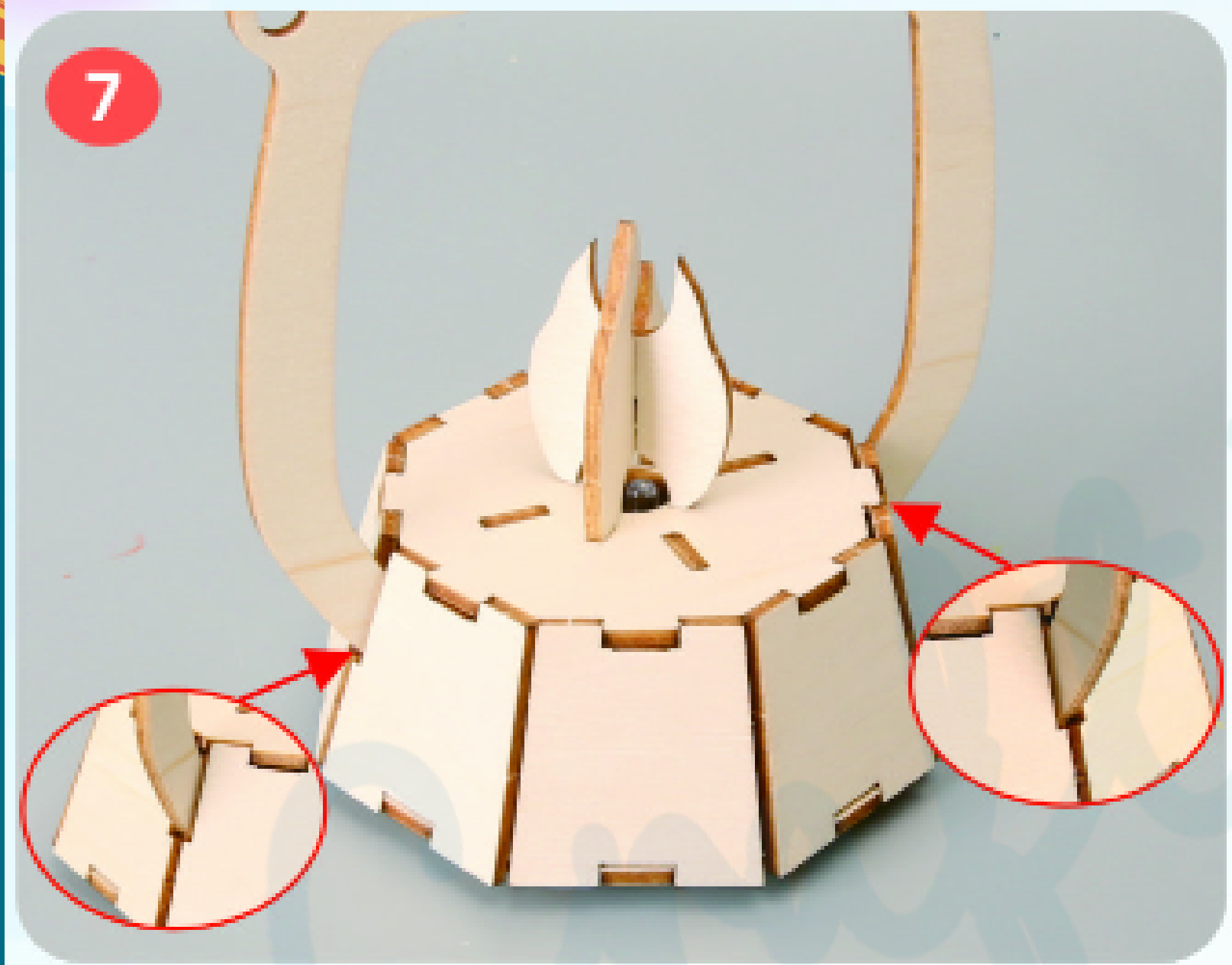

Install the wooden boards as shown — refer closely to the picture.

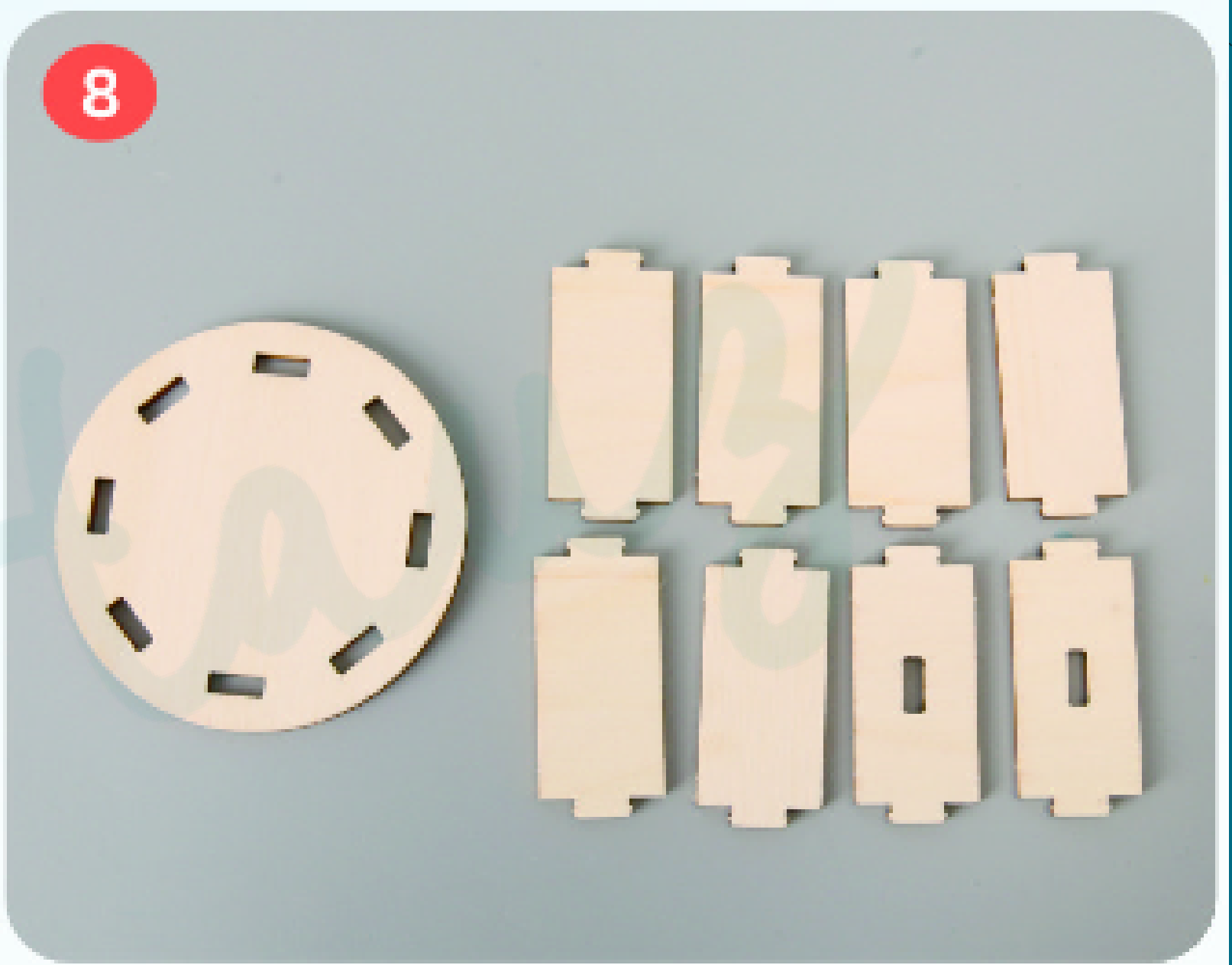

Prepare the wooden boards shown in the picture.

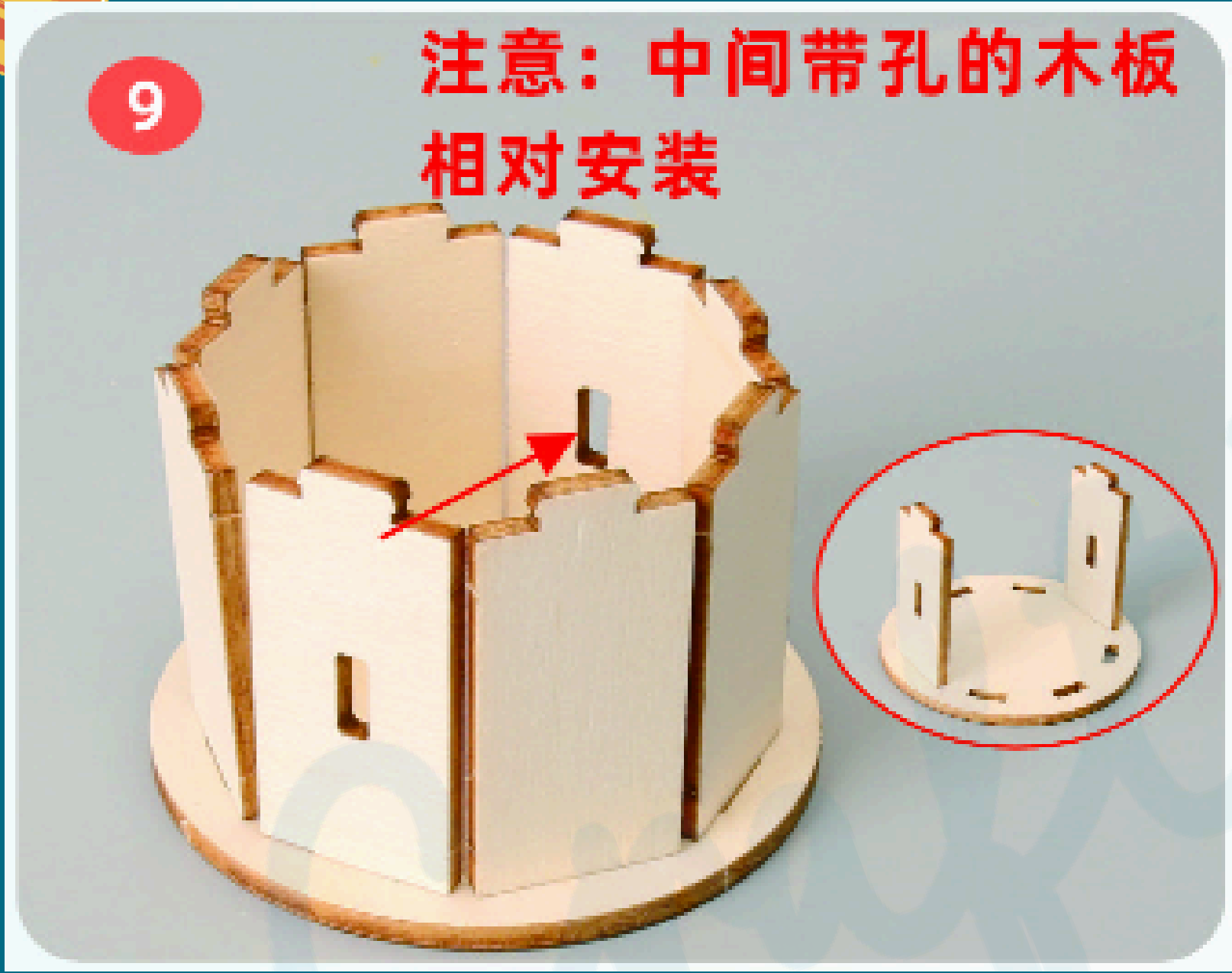

Install the wooden boards as shown.

Note: Position the boards with holes in the center facing each other.

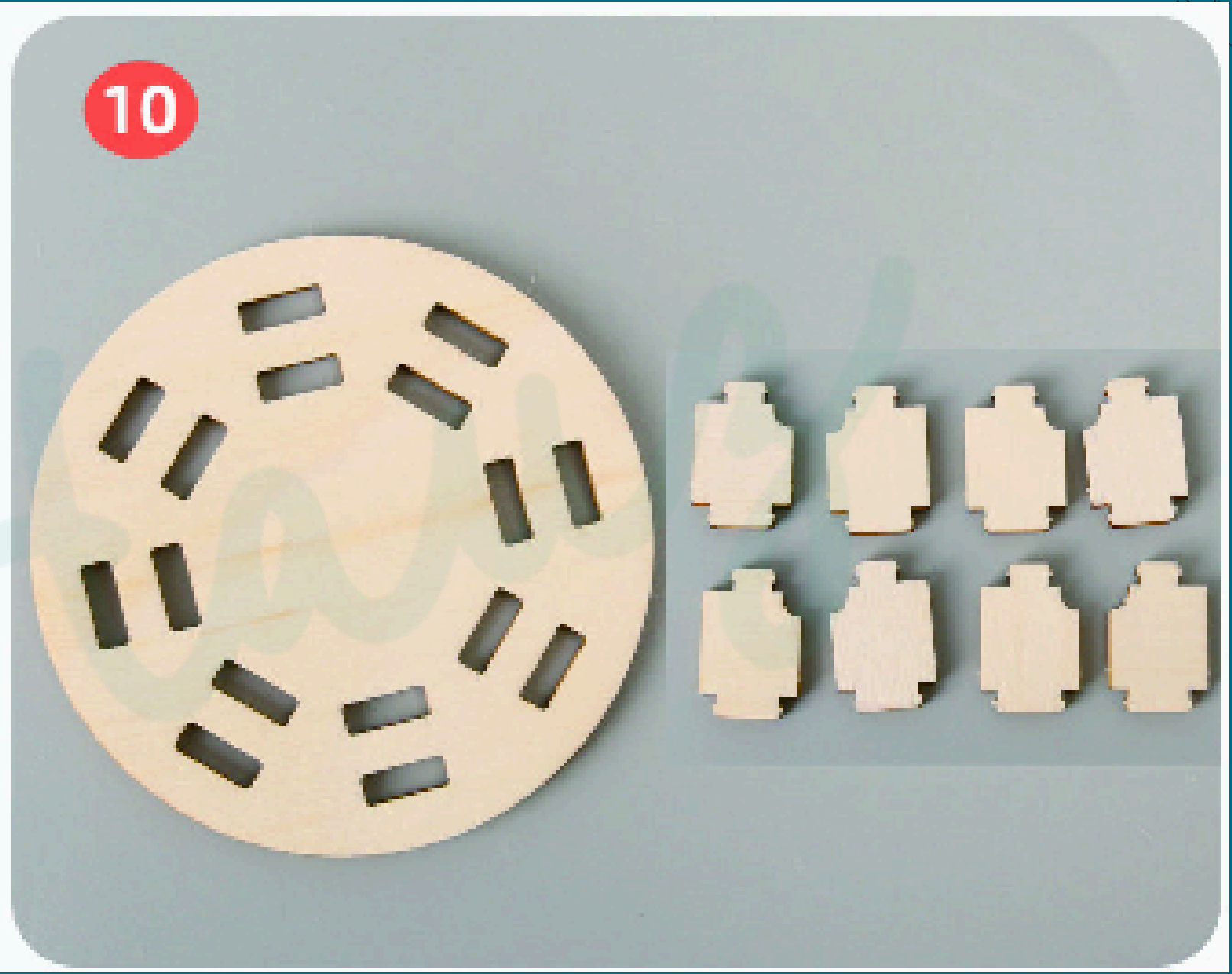

Prepare the wooden boards shown in the picture.

11

注意：带有缺口的一边安装在一起

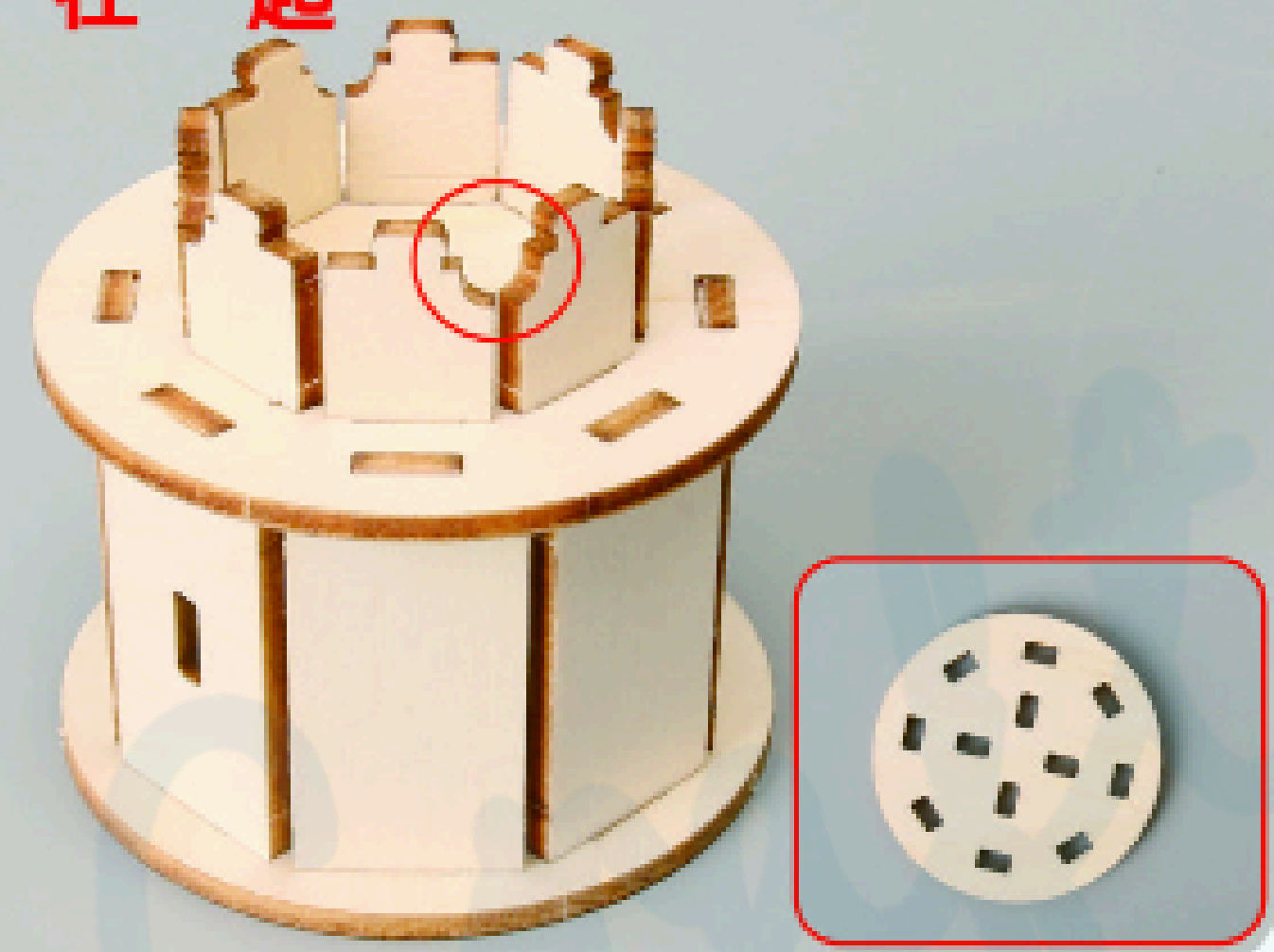

12

注意：木板对齐之后容易卡入

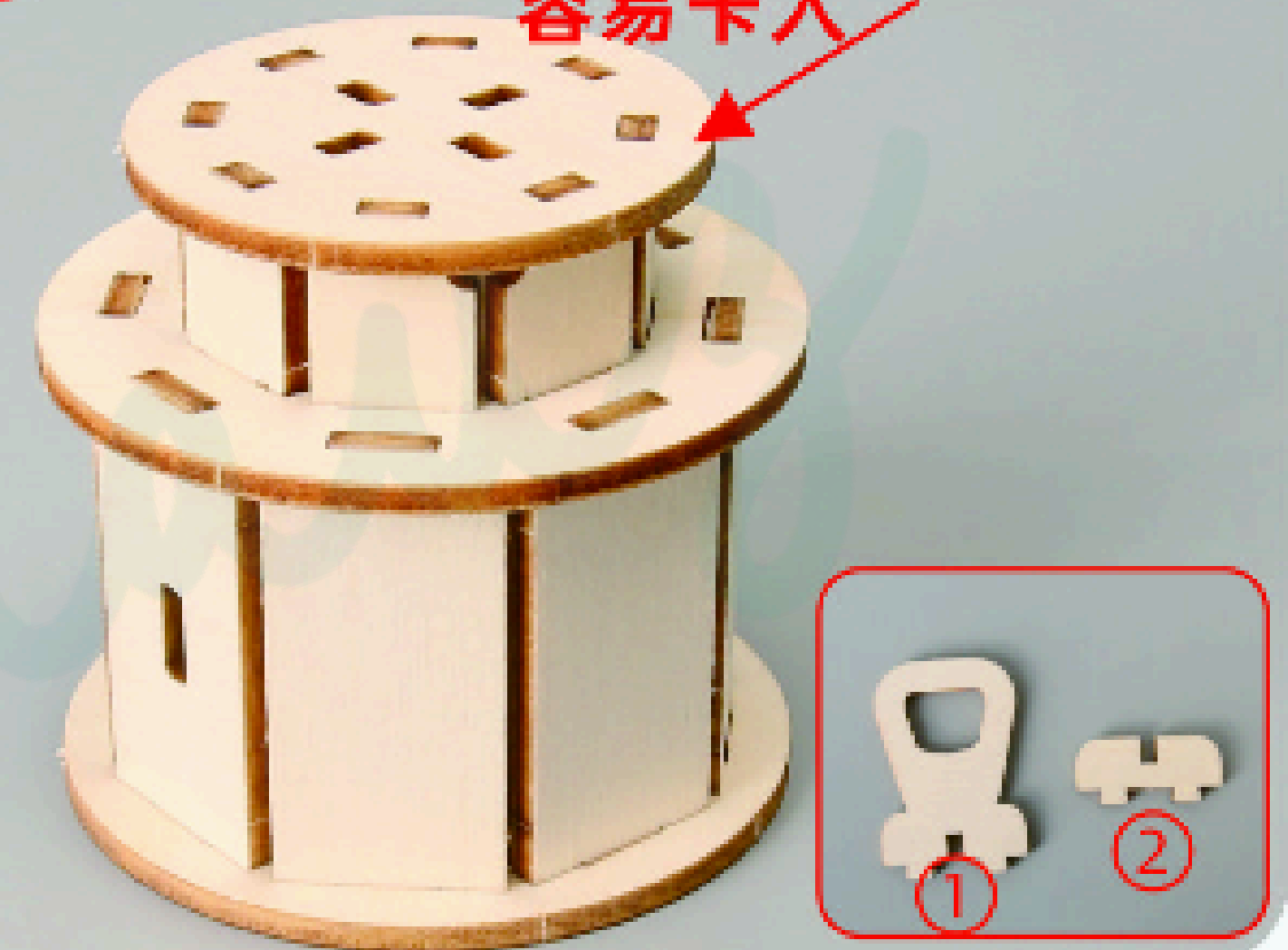

Install the wooden boards as shown.

Note: Place the sides with notches together.

Insert the boards into the assembly from Step 11 as shown.

Note: They will slide in easily once aligned properly.

Prepare the materials for the next step. Refer closely to the picture.

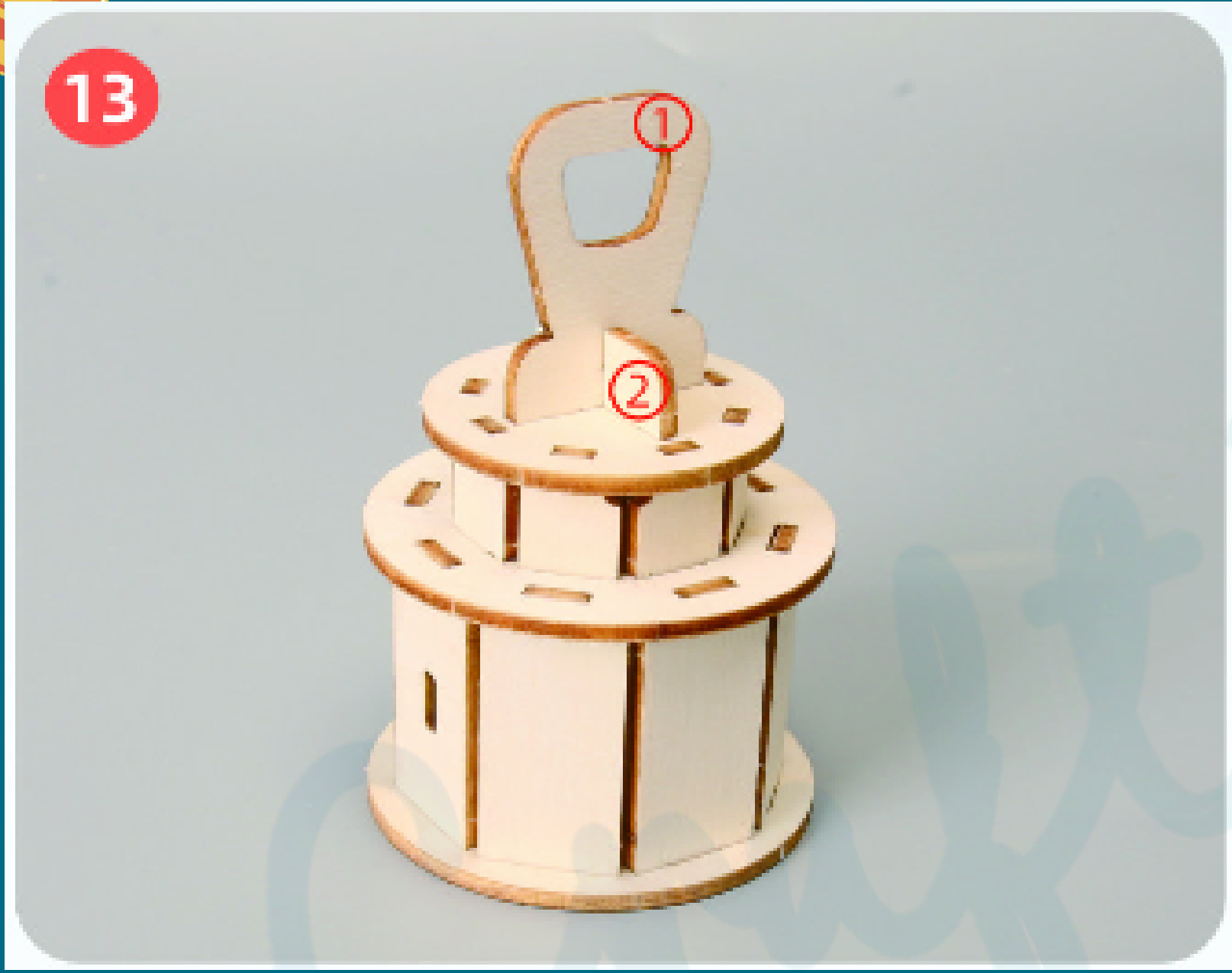

Insert Board 2 first, then insert Board 1, as shown.



Attach the assembly from Step 13 to the assembly from Step 7 as shown.

Note: Insert diagonally from both sides at the arrow marks into the square holes.

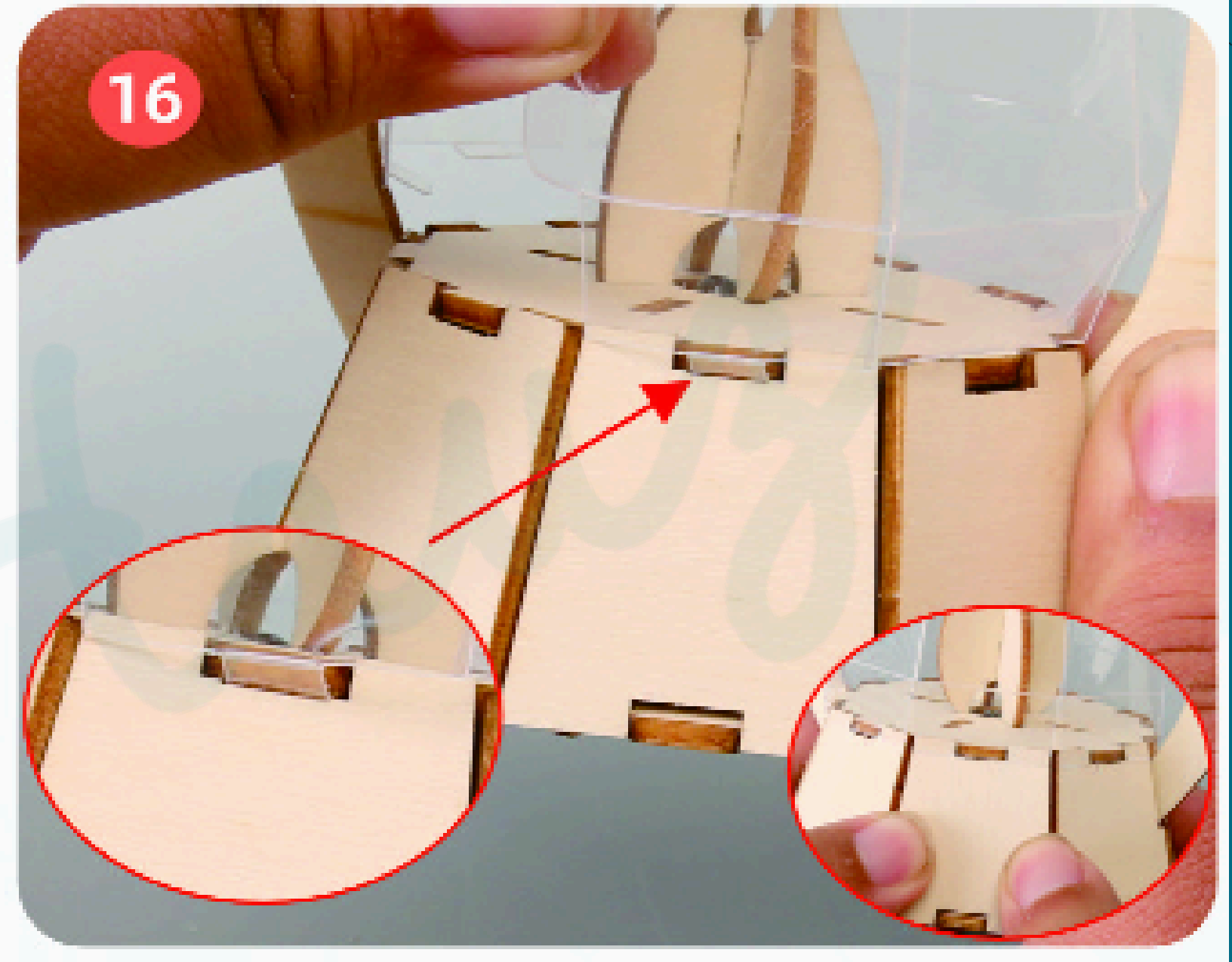
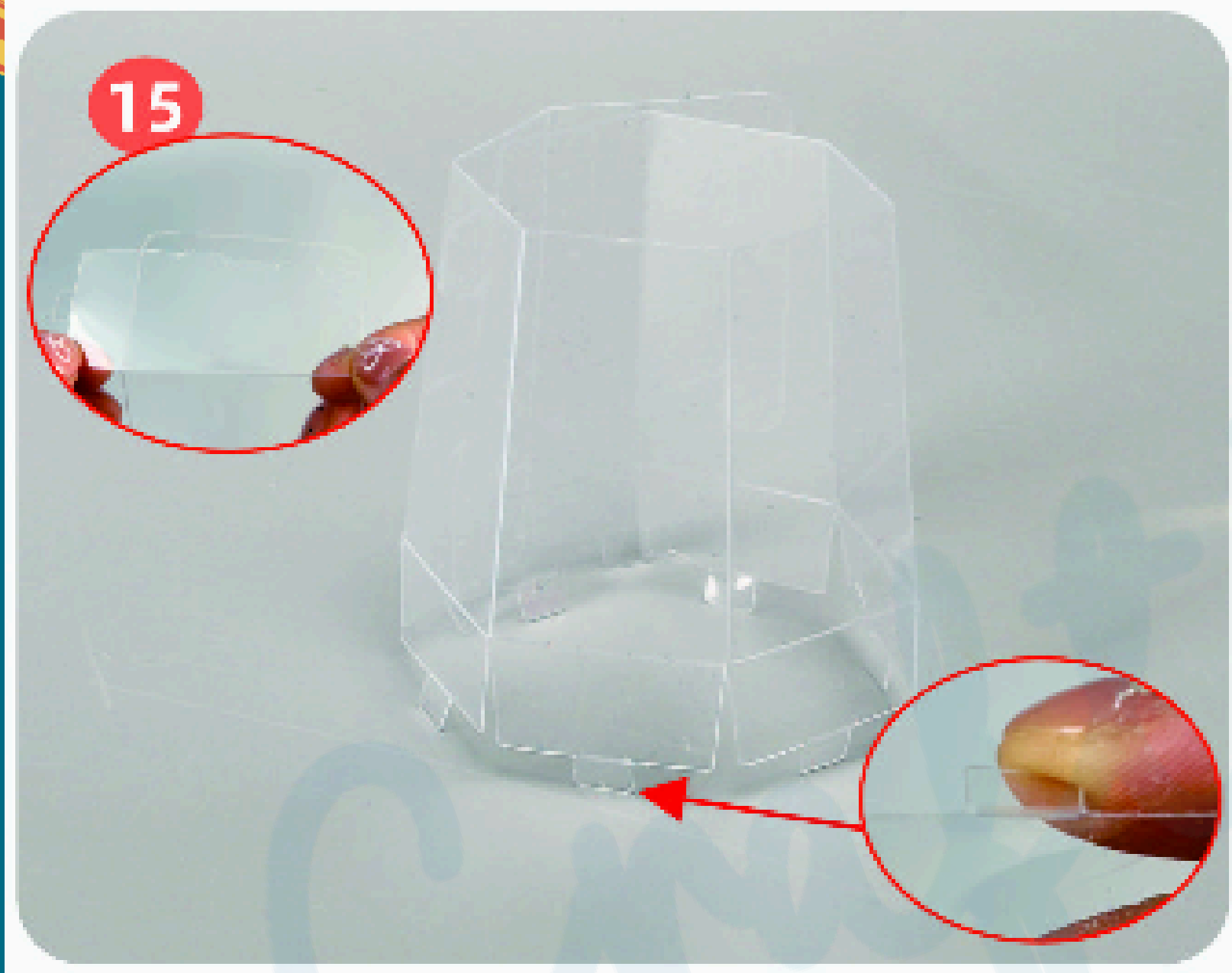

Pre-fold the crease lines on the plastic lampshade as shown — this will make installation easier later.

Insert the plastic lampshade into the small square holes on the wooden board as shown.
Note: Push the wooden board upward to lock it in place after insertion.

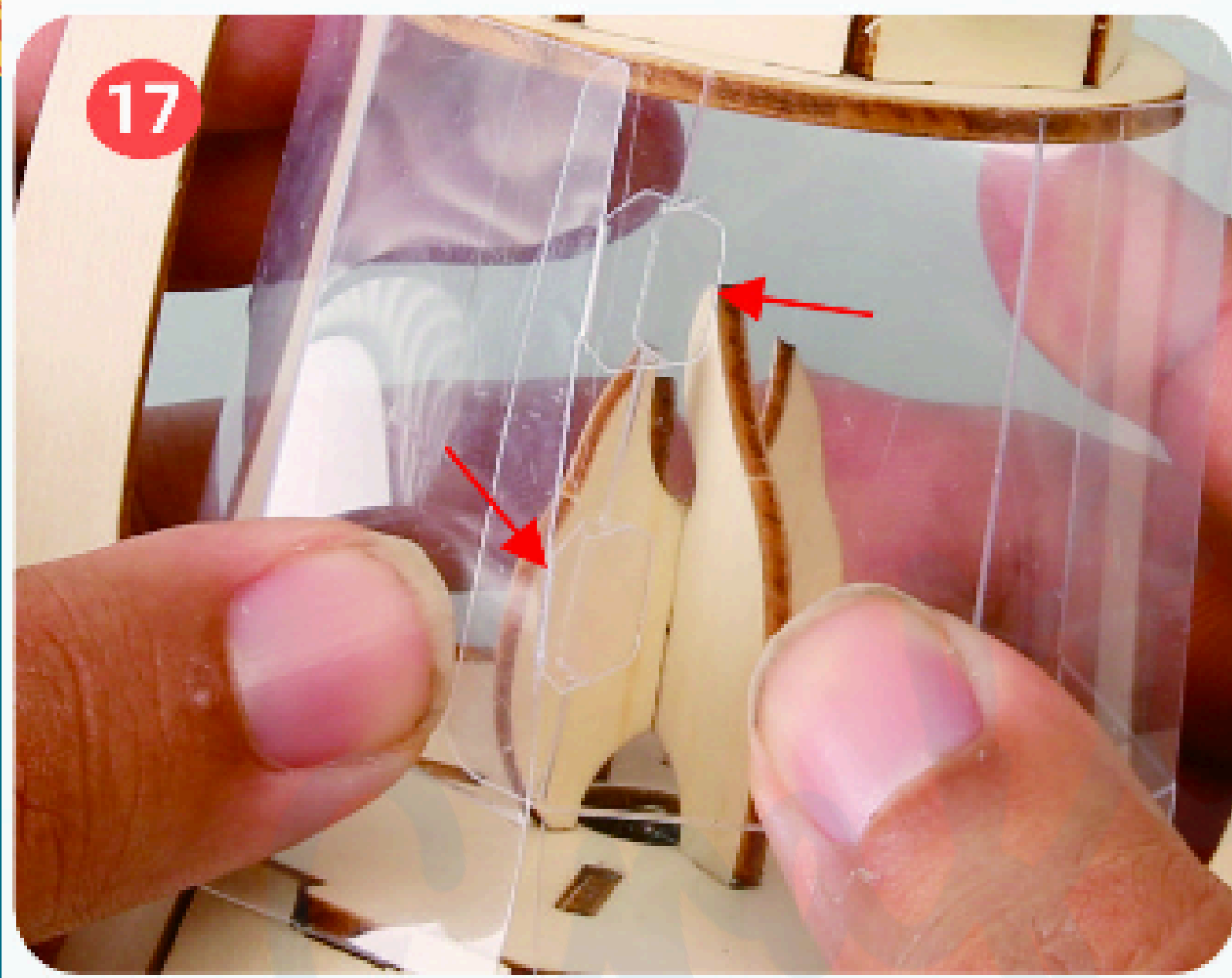

Fasten the clips on the plastic lampshade as shown.
Note: Fasten tightly so the shade does not come loose.



Tie the hemp rope on both sides as shown — your small portable lantern is now complete!



Experimental Principles

This small portable lantern is built around three fundamental scientific principles: electrical circuit conduction, light propagation, and structural mechanics. It combines simple materials to achieve the functions of producing light and being portable.

The handle design makes it easy to hold, while optical properties are used to improve lighting efficiency. The result is a compact lighting tool that is convenient to carry and use.